

SHEET DATA

UNO eco connection

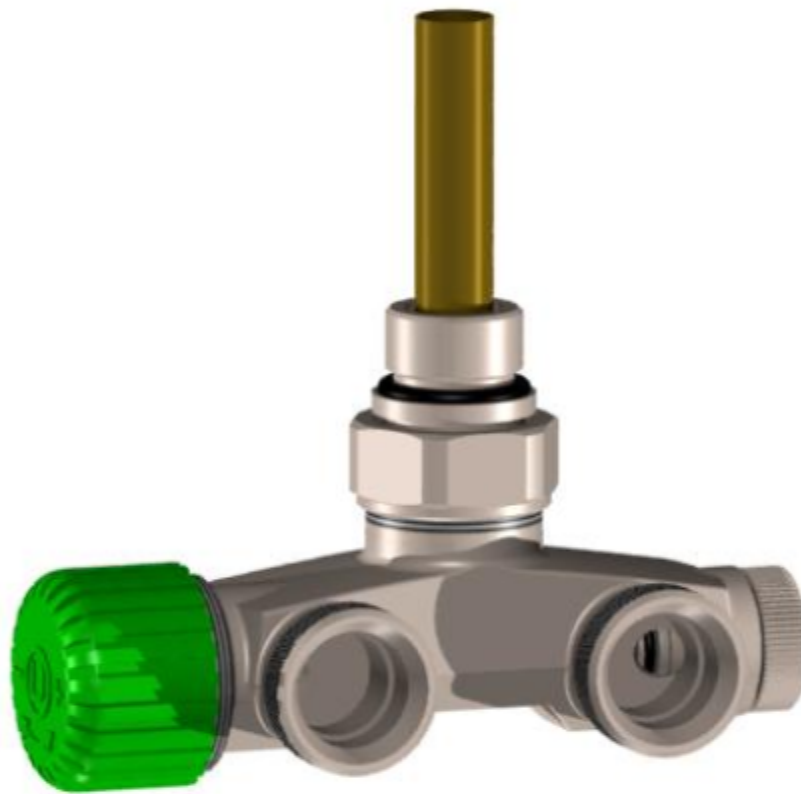

APPLICATION

The UNO eco connection is specially designed for bathroom heaters with vertical manifolds for use in the heating of the heating element used in the summer to heat the heater and use as a dryer 50 mm connection distance.

The UNO eco port regulates the flow of water coming out of the heater and also has a water shut-off function. The UNO eco terminal is designed to be mounted under a head-to-wall heater, inside the radiator contour, to prevent accidental damage.

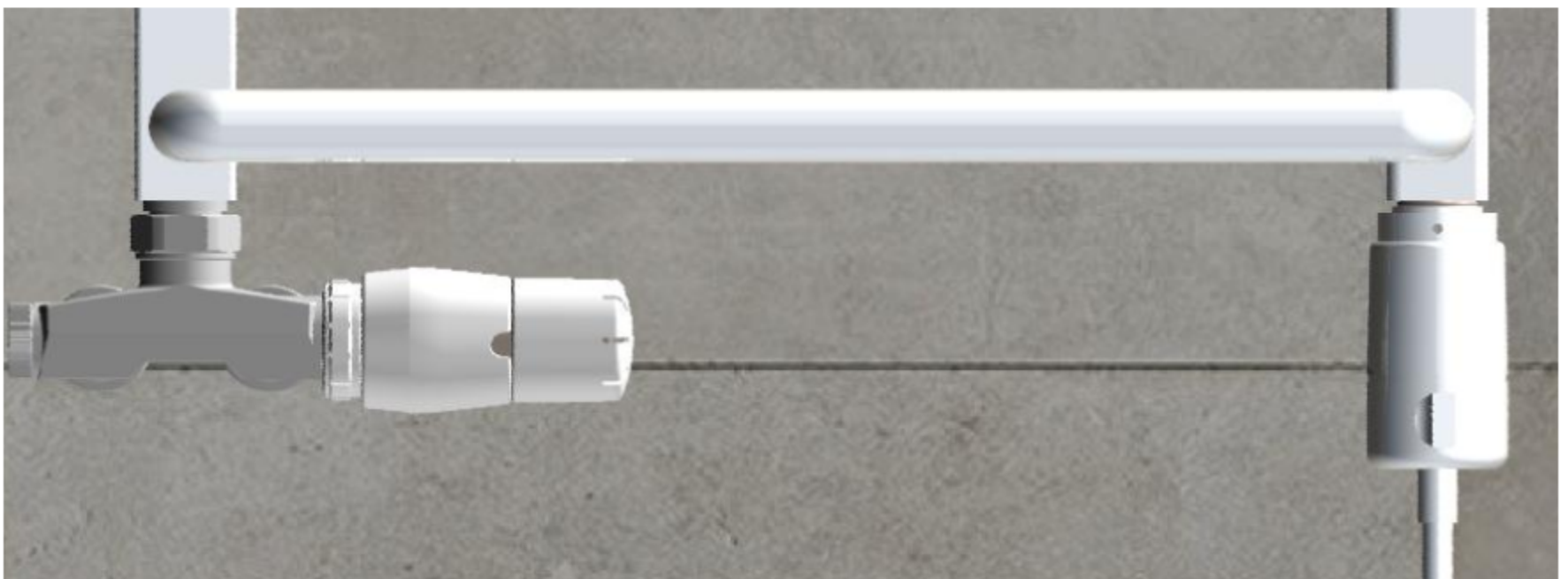

SPECIFICATION

Working temperature	120 °C
Nominal pressure	1 MPa
Heating factor	water
Test pressure	1,5 MPa
Pressure difference	0,06 MPa
Hysteresis	0,3 °K
Presetting	on the shut-off insert

Presetting and corresponding Kv coefficients:

Diagram przepływów dla wkładki termostatycznej przyłącza UNO eco

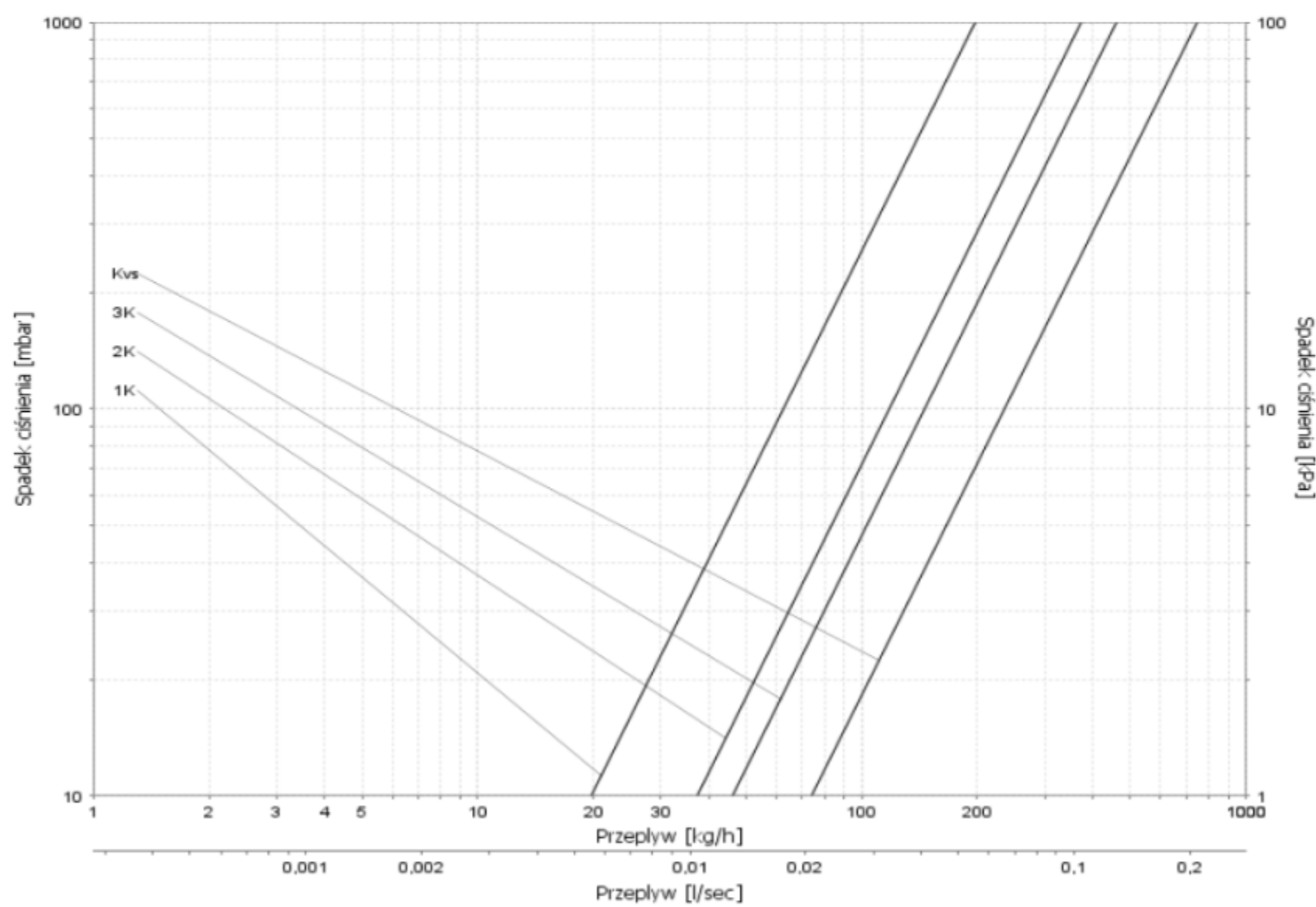

Deviation Proportional	1K	2K	3K	Kvs
Kv	0,19	0,37	0,46	0,74
Tolerance	± 10%			

Diagram przepływów dla wkładki odcinającej przyłącza UNO eco

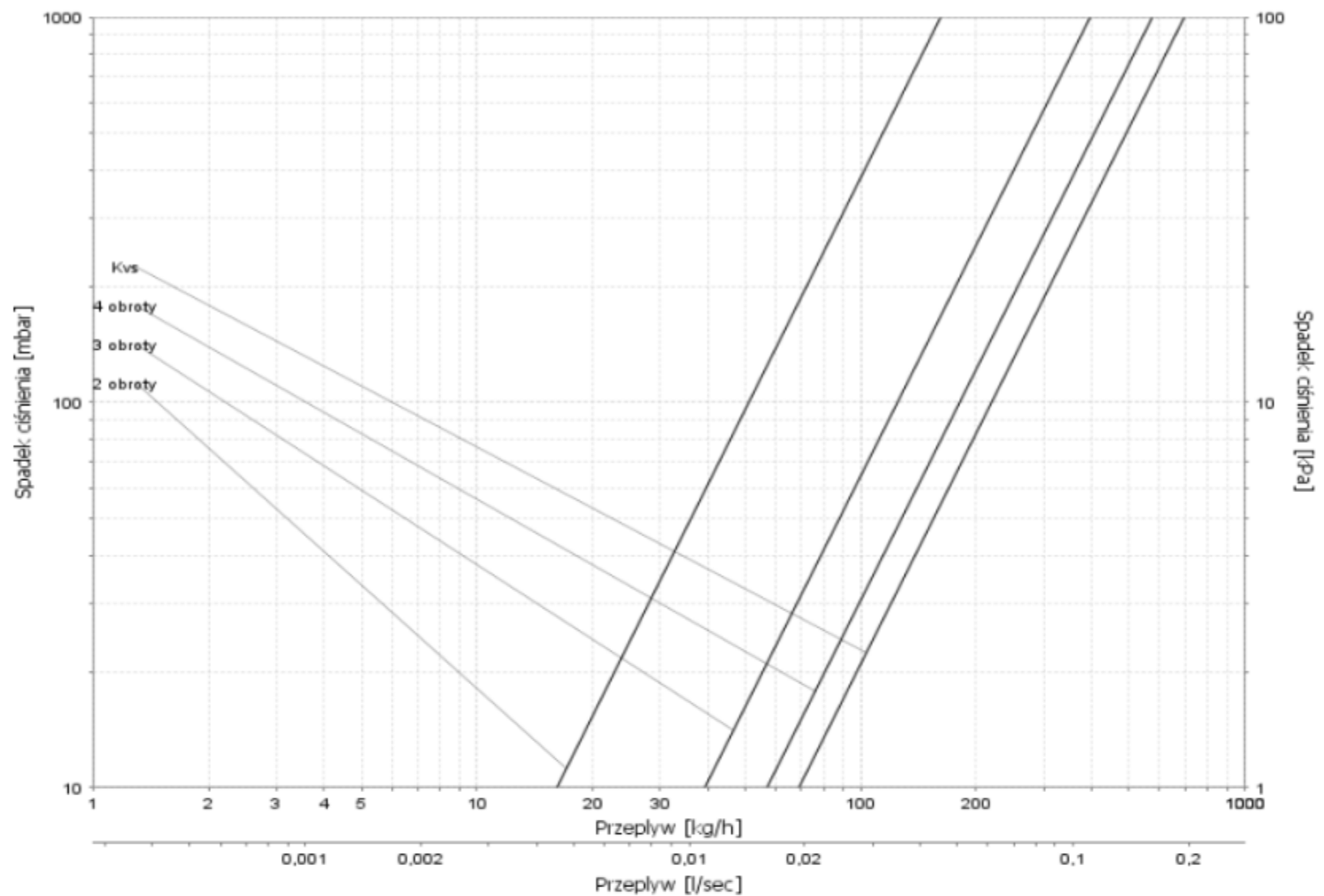

Number of turns	2	3	4	Kvs
Kv	0,16	0,39	0,57	0,65
Tolerance	± 10%			

Attention:

- Thermostatic heads mounted on the return side (used on the left side, attached to the radiator, the thermostatic head should be on the right side).
- UNO eco connections are terminated in the open position at the factory.
- The presetting in the UNO eco connection can be operated with a split blocking insert. To change the presetting, it must be locked with a dividing blocking insert and then use Allen coupling aid. The initial method for a returnable insert is a very convenient method limited and is recommended by the manufacturer.

Construction of the UNO eco connection

1. UNO connection body
2. Thermostatic insert
3. Shut-off insert
4. G 1/2 screw
5. Separation sleeve
6. Directional tube
7. Adjusting knob
8. Cap

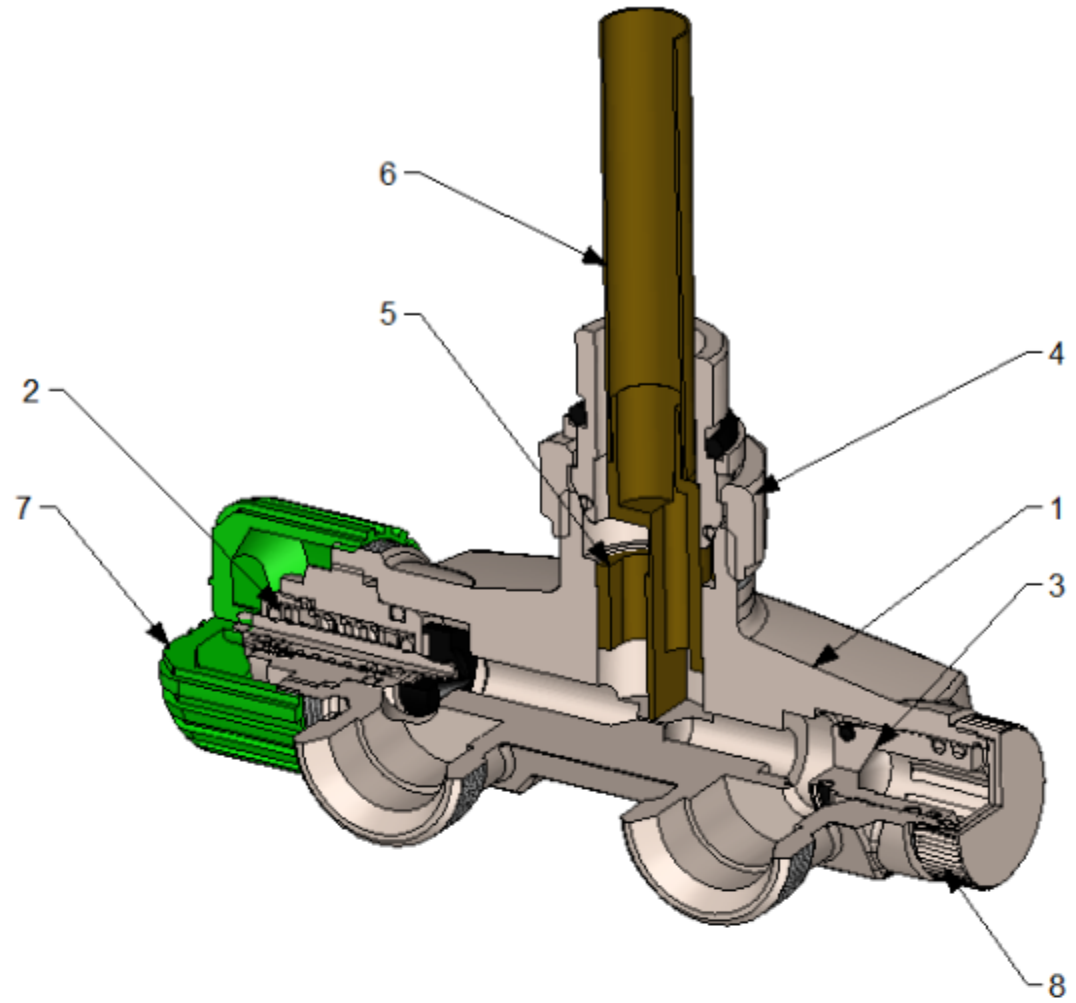

Correct assembly of UNO connector eco for installation / operating principle:

- RIGHT version

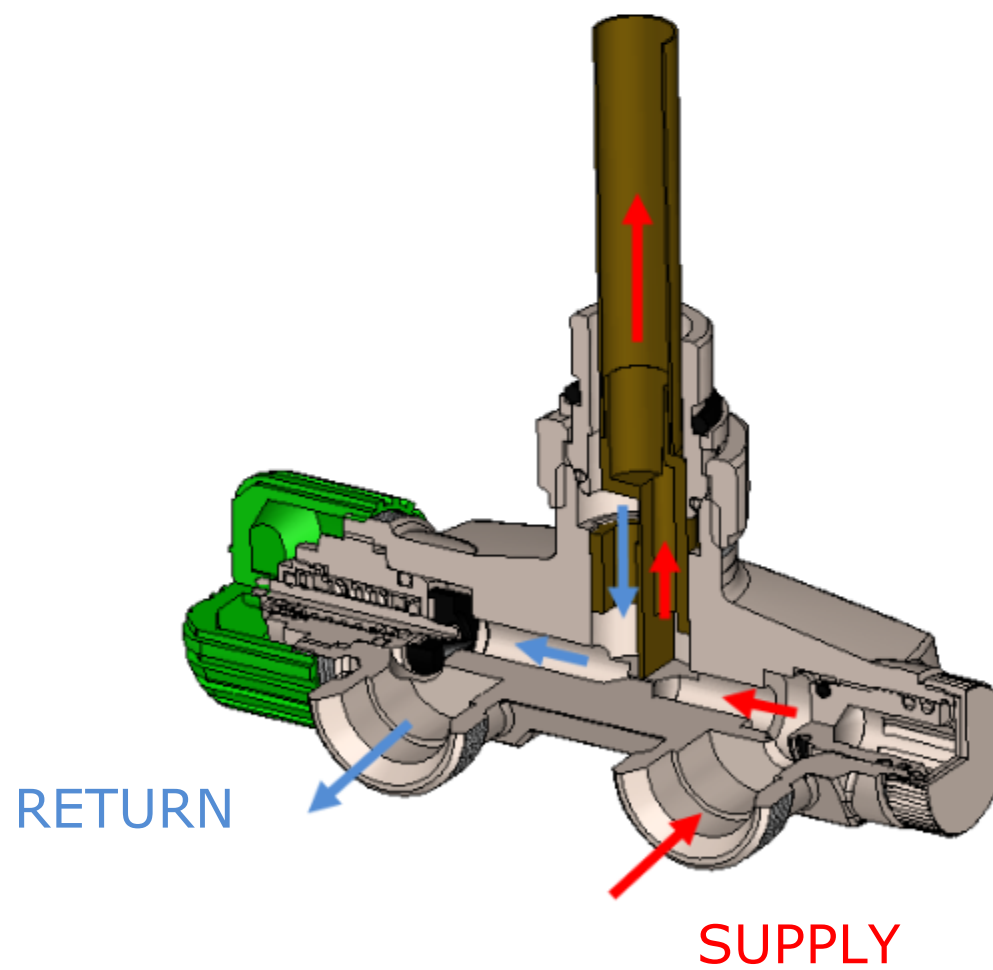

The heating medium stream supplying the radiator is connected through a return valve and directed to a separating sleeve connected to a directional pipe which directs it to the upper zone of the radiator. The heating medium returns on the outer surface of the distribution sleeve and is directed towards the insert of the thermostatic valve, and then to the connection and heating system return.

DIMENSIONS

(with thermostatic head GS.05 Trends)

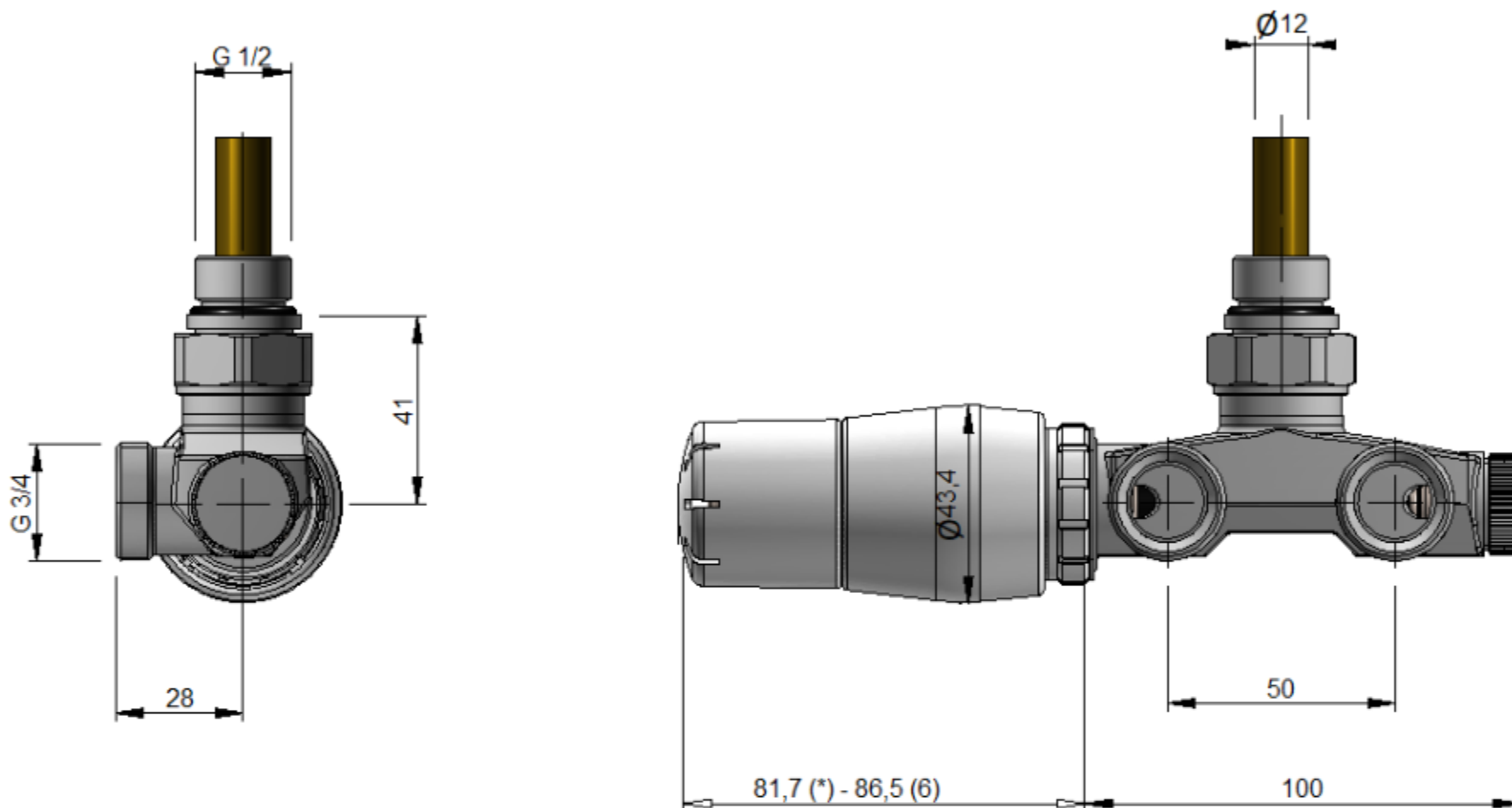

VERSIONS

All color performance are available on our website: www.varioterm.pl

CONNECTION ACCESSORIES

(useful for connecting the valve and aesthetic finish of the installation)

	<p>Pex 16x2 (GW $\frac{3}{4}$), Cu 15x1 (GW $\frac{3}{4}$) adapters and R 1/2 coupling</p>
	<p>Rosette masking double $\frac{1}{2}$" or 50mm spacing</p>
	<p>Pex / Cu tube masking sleeves (various lengths)</p>